

Portable Folding Ramp



DUNLOP AR02

Light and portable.
Applicable to narrow entrances.



The Lightest
in the Industry*



Effective width
of 69cm to fit
any doorway



Reduced impact
riding on
the ramp



Reduced
Maintenance
Time for Rental
Companies



More comfortable
and safer for both
users and helpers



"Dunlop AR02" has obtained a
JIS certificate and its reliability
is guaranteed.

JQ0518008
Portable Folding Ramp for wheelchairs
(Integated model)
JIS T 9207:2015

*Comparison to other companies on
JIS certified ramps
(According to our research as of August, 2020)

MADE IN JAPAN

Rental Product applicable to
Japan Long-Term Care Insurance
Patent and design pending

Features of DUNLOP AR02

1 Lightest Weight in the Industry ※

As the leading portable ramp manufacturer, using technology of our years of experience in reducing weight, safety, reliability and design, we developed the lightest weight slope.



High-quality special carbon fabric used for aircraft and racing cars is adopted. Using simulation technology, we designed a lightweight, highly durable hollow structure.

※ Comparison to other companies on JIS certified portable ramps.
(According to our research as of August, 2020)

2 Reduced impact when riding on

We reduced the impact on wheelchairs when riding onto the ramp to the minimum. It is user-friendly.

3 Improved General-Purpose Versatility

We reduced the width of all sizes to less than 70cm so that they are applicable to entrances that have been impossible to set up. In addition, the handles will not interfere. Variation of sizes comes with 7 sizes and they are usable for various residential environments.



Effective Width
69.0cm



R-205Z-E

4 Enhanced Safety

Side edges keep you on the track. By using protection rubber, the risk of pinching fingers that tends to happen when folding is reduced. To set the ramp at the right position, a large, easy-to-understand mark is displayed to secure safe use



3cm high edges and protection rubber



Installation position marks help setting the ramp properly

5 Improved Maintainability

Repair works at rental shops are simplified



The handle part is easier to repair by using screws



Repairability is simplified because the anti-slip sheet on the running surface is partially laminated.



Rubber parts of the top and bottom can be easily replaced using double-sided tape.



Repairability is improved since the edge sheet is replaced with colored edge protection material.

How to use DUNLOP AR02



1 Bring the ramp to where it is needed

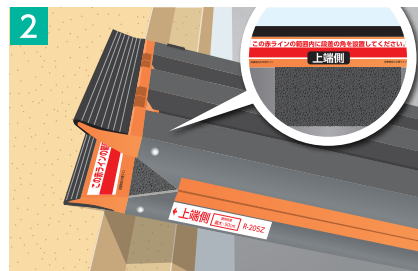

2 Place the red line on the upper end with the edge of the step

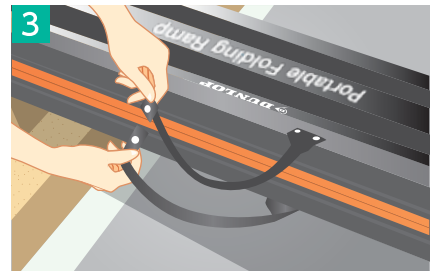

3 Unbuckle the stopper

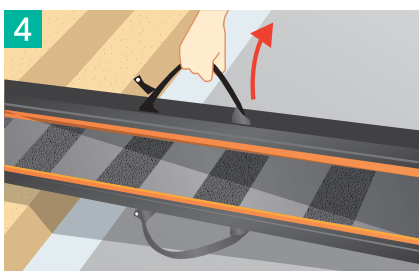

4 Pull the handle up

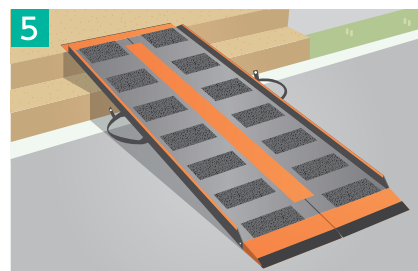

5 Unfold it



6 Please check the safety before using

How to Select Best DUNLOP AR02

No Assistant needed
Gentle Gradient

Incline angle approx. **5°**

Ramp length is about **12 times** the height of steps

At this incline, the user can operate the wheelchair on their own



Assistant needed
Basic Gradient

Incline angle approx. **10°**

Ramp length is about **6 times** the height of steps

Basic incline for wheelchairs to operate with an assist of caregiver



Assistant needed
Maximum Gradient

Incline angle approx. **14°**

Ramp length is about **4 times** the height of steps

Quite steep slope. Please refrain from using it at any greater angle

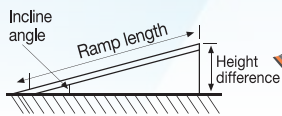

Gentle Gradient (about 5°)

Basic Gradient (about 10°)

Maximum Gradient (about 14°)

R-285Z-E	23cm	46cm	70cm
R-255Z-E	20cm	41cm	62cm
R-230Z-E	18cm	37cm	56cm
R-205Z-E	16cm	33cm	50cm
R-165Z-E	13cm	26cm	40cm
R-125Z-E	10cm	20cm	30cm
R-85Z-E	6cm	13cm	20cm

Line Up

Trade Name		R-285Z-E	R-255Z-E	R-230Z-E	R-205Z-E	R-165Z-E	R-125Z-E	R-85Z-E	
Specifications	Length (Running Surface)	285cm	255cm	230cm	205cm	165cm	125cm	85cm	
	Width	When used	69.6cm			69.4cm			69.6cm
		Effective width When stored	34.8cm			34.7cm			34.8cm
	Thickness when stored	10.8cm							
	Net Weight	Approx.: 11.5kg	Approx.: 10.5kg	Approx.: 9.6kg	Approx.: 8.5kg	Approx.: 7.0kg	Approx.: 5.7kg	Approx.: 4.3kg	
	Packaging Dimension (cm)	L 287 x D 40 x H16	L 257 x D 40 x H16	L 232 x D 40 x H16	L 207 x D 40 x H16	L 167 x D 40 x H16	L 127 x D 40 x H16	L 87 x D 40 x H16	
	Gross Weight	Approx.: 14.8kg	Approx.: 13.5kg	Approx.: 12.4kg	Approx.: 11.1kg	Approx.: 9.3kg	Approx.: 7.6kg	Approx.: 5.8kg	
	Edges	Height	2.7cm						
		Width	0.34cm			0.26cm			0.34cm
	Maximum Load Mass	300kg							
	Maximum Applicable Level Difference (Angle 14°)	70cm	62cm	56cm	50cm	40cm	30cm	20cm	
	Material	Carbon FRP/Polycarbonate							



Warnings

- The slope should only be used by wheelchair users and their caregivers.
- Do not weight only on one side of the running surface of the ramp.
- The maximum load is 300 kg. Do not overload beyond this maximum load.
- Do not add an impact to the resin part on the upper and lower ends (e.g. stomping on hard, hitting at the time of installation or carrying, letting it fall when it is standing). It can cause damage to the ramp.
- Do not add an impact with pointy objects such as high heels or umbrellas.
- Do not use this on a slippery surface such as sand, snow or ice, or on an uneven surface with rocks or protrusions.
- Do not add any modification without authorization from the manufacturer.
- Do not use this for any purpose other than the described use (ex: carrying objects or walking).
- Do not install this permanently.
- Do not fix the ramp with screws and anchors.
- Do not make a sudden stop or change of direction on the ramp.
- When installing or carrying the ramp, do not drop, hit against an object or drag it.
- If the step or the overturning prevention metal of the wheelchair is not set properly, the running surface of the product can be damaged. Use the product after setting them properly so that they will not touch the surface.
- Be careful not to pinch your finger when installing or storing the ramp.
- Referring to the page of applicable level difference, use the ramp size that is suitable for the height of the level difference to set up the ramp.
- Check the marked "Top" and set up the top and bottom properly.
- Check the marked "Back" and set up the front and back properly.
- Inspect each part before use and check if there is any abnormality such as scratches, cracks, rattling, peeling rubber parts, peeling of sliding prevention sheet on the running surface or if there is any foreign object attached to the running surface.
- Use both top and bottom of the ramp on a flat surface. Check if there is any rattling after setting the ramp.
- Align the corner of the step within the top red line of the, ramp set it parallel to the step and be careful not to excessively overlap the top of the ramp (adequate depth of overlapping: 5 cm from the top).
- This ramp is twofold. Extend before use.
- Enter the ramp slowly and straight, and make sure the ramp does not cause misalignment when entering.

- Pass carefully to avoid running off. Proceed in the center carefully so that either side of the wheels and the hand rim of the wheelchair will not hit against the edge of the ramp.
- When going up on the ramp, go up forward in the direction of where the helper pushes the wheelchair to. When coming down, the helper should move backward as he or she is receiving the wheelchair.

Reminders for Storage and Maintenance

- Do not leave the ramp after use. Children can get hurt by playing on it. They can fall if the ramp goes off the steps and it can lead to an accident.
- Do not leave the ramp in direct sunlight, high heat, or in the rain. The rubber and resin part will easily deteriorate. Also, it can cause attachment of dirt such as sand and discoloring.
- Do not leave it leaning against a wall. It can fall. Also, if the ramp is left-leaning for a long time, it can cause damage or distortion of the rubber.
- Do not hook the handle part onto a hook. Avoid storing the ramp with weight on the handle part.
- Do not put wax or oil for tires on the rubber part of the top and bottom. They make it slippery and it can lead to falling and sliding.
- Avoid disinfection by ozone. It can cause deterioration and cracking of the rubber.
- Do not dry this product in a dry warehouse where the temperature is over 60°C
- Let it dry naturally.
- Do not use a detergent that contains strong alkali or strong acid. They can cause deterioration and cracking of the rubber. Use household detergent instead.
- When washing, do not use hot water (over 60°C).
- When using a high-pressure cleaning machine, do not directly splash water on the joint part of top resin and running surface, and the adhesive surface of rubber parts. It can cause damage or water intrusion into the inside of the ramp.
- Clean the dirt off after using the ramp and store it by laying down horizontally in a place where it is not exposed to rain or wind.
- Regularly inspect if there is wobbling of the resin portion of both top and bottom parts, a loose screw in the handle part, cracking in the body or peeling of the non-slip strip of the running surface.

SUMITOMO RUBBER INDUSTRIES, LTD.

Hong Kong Sumirubber, Ltd.

UNIT 09, 5/F, TOWER 1, SILVERCORD,
30 CANTON ROAD, TSIMSHATSUI, KLN., HONG KONG

Tel: (852) 2736-1217 Fax: (852) 2736-1216

www.dunlop-care.com info@dunlop-care.com

The catalog does not include complete information regarding product performance and quality. Please contact the company or a retail outlet for details.

Product specifications and catalog content may be altered without prior notice.