



MISSYCARE
bridging the needs.

User Manual

Guja 18



**Lightweight 18\"
Detachable
Wheelchair**

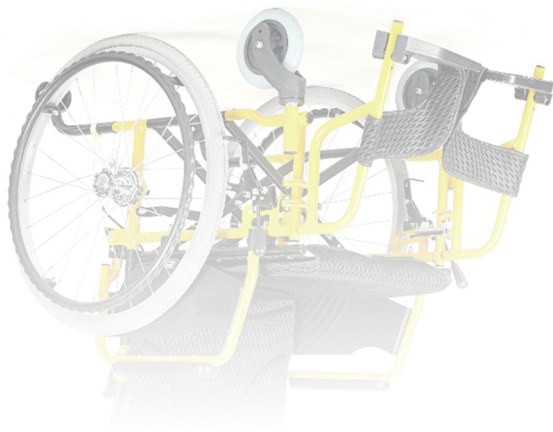

Guji 18



**Lightweight 18\"
Detachable
Pushchair**



1. User Guide

It is very important that the users and caretakers read all the instructions before using the equipment. It is the user's responsibility to use the equipment correctly according to the functions it is designed for.

1.1 Composition of Guja & Guji

Guja 18" Lightweight Detachable Wheelchair

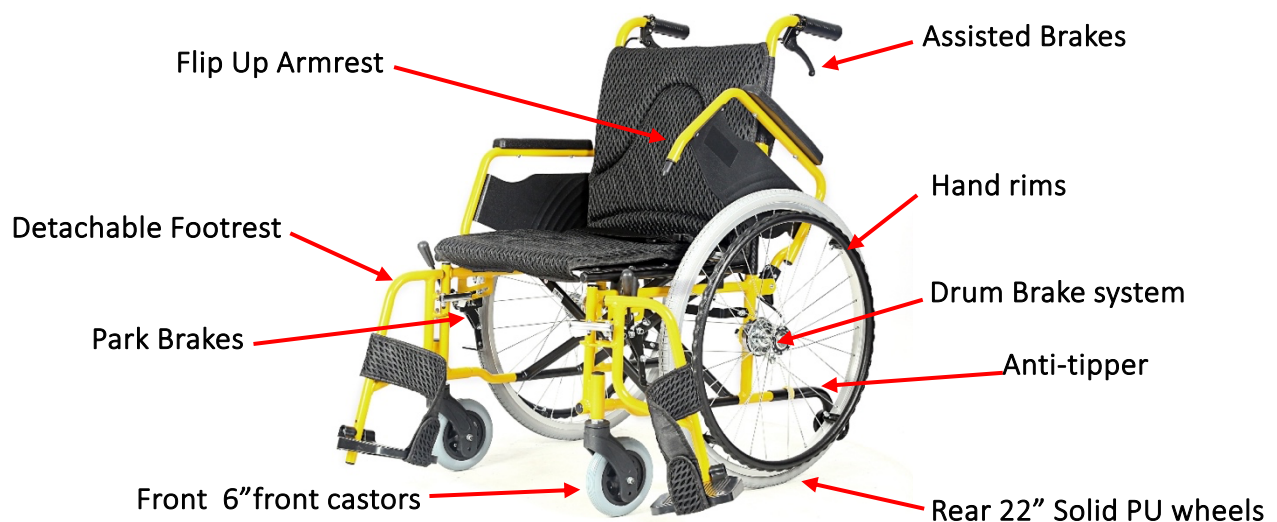

Guji 18" Lightweight Detachable Pushchair



1.2 Main Technical Data



Guja 18 Specifications		
Model No	MissyCare MC-1001-Guja 18	
Seat	Width	18"
	Depth	16"
Floor to Seat Height	18"	
Backrest Height	16"	
Net Weight	13.5 kg	
Max User Weight	120 kg	
Expanded Overall Width	23"	
Expanded Overall Length	37"	
Expanded Overall Height	34"	
Folded Upright Width	9"	
Folded Upright Length	23"	
Folded Upright Height	24"	
Features	<ul style="list-style-type: none"> ▪ Durable strong aluminum frame chassis ▪ Foldable backrest for compact car boot storage ▪ Removable breathable seat & backrest cushions ▪ Detachable footrests & flip-up armrests for ease of transfer ▪ Effective & durable Japanese drum braking system. ▪ 6" solid PU tires front wheels ▪ 22" Puncture-free solid PU tires rear wheels ▪ Anti-tipper to prevent rear-tipping. ▪ Safety Belt included 	
Warranty	<ul style="list-style-type: none"> ▪ One year on frame chassis & brakes against manufacturing defects, faulty materials and workmanship only ▪ Any alterations, misuse, abuse, or accidental damage void this warranty 	

1.3 Main Technical Data



Guji 18 Specifications		
Model No		MissyCare MC-1001-Guji 18
Seat	Width	18"
	Depth	16"
Floor to Seat Height		18"
Backrest Height		16"
Net Weight		12 kg
Max User Weight		120 kg
Expanded Overall Width		23"
Expanded Overall Length		37"
Expanded Overall Height		34"
Folded Upright Width		12"
Folded Upright Length		27"
Folded Upright Height		24"
Features		<ul style="list-style-type: none"> ▪ Durable strong aluminum frame chassis ▪ Foldable backrest for compact car boot storage ▪ Removable breathable seat & backrest cushions ▪ Detachable footrests & flip-up armrests for ease of transfer ▪ Effective & durable Japanese drum braking system. ▪ 6" solid PU tires front wheels ▪ 16" Puncture-free solid PU tires rear wheels ▪ Anti-tipper to prevent rear-tipping. ▪ Safety Belt included
Warranty		<ul style="list-style-type: none"> ▪ One year on frame chassis & brakes against manufacturing defects, faulty materials and workmanship only ▪ Any alterations, misuse, abuse, or accidental damage void this warranty

2. USAGE AND SAFETY

2.1 Unfolding and folding of manual wheelchair

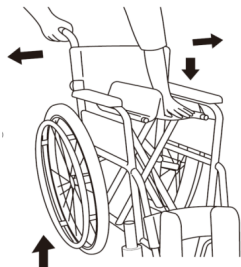

Push down the seat frame gently to open the wheelchair for usage.

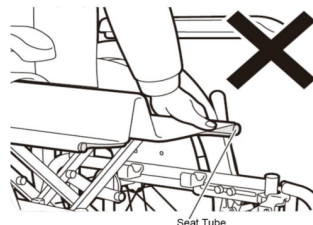

Do not hold seat tube when pressing down the seat in case fingers are pinched



Pull up the seat upholstery gently to close the wheelchair

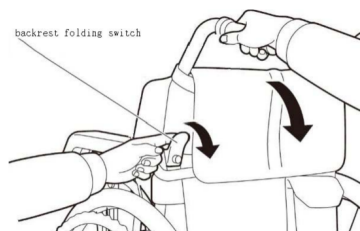

Flip up the Footrest, and pull the backrest folding levels and fold backwards

2.2 Getting off and on the wheelchair

When getting off or on the wheelchair, please make sure the front castors are set backwards, park brakes, and flip up the footrests. Users should hold onto the armrests for balancing support to get off or on with help of a caregiver if the user is very weak.

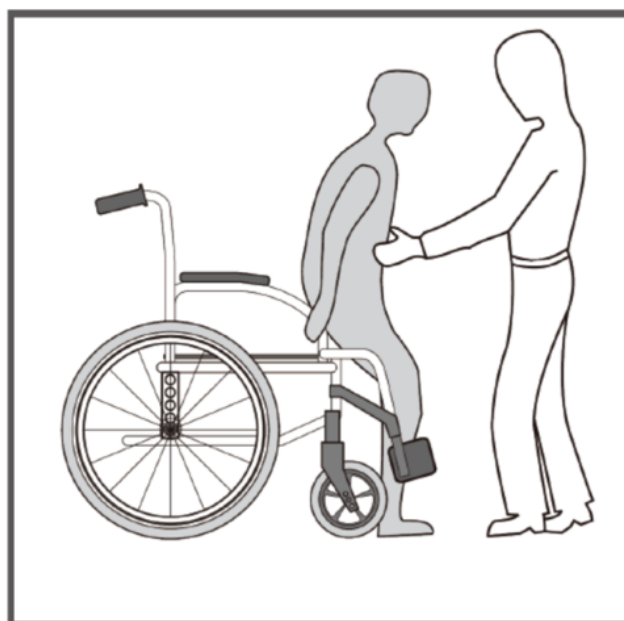

2.3 Parking brake

Pull the brake backward till the wheelchair is locked and secured. Pulling forward to the original position will release the brake. Refer to the pic below.

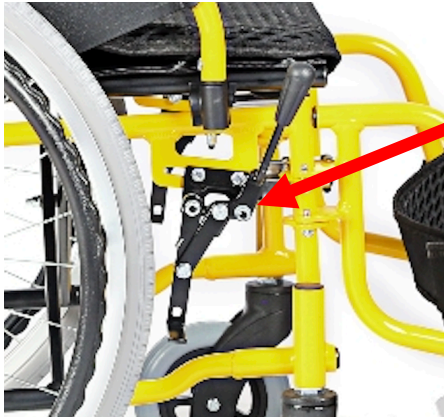

Note: *The parking brake is designed to park the wheelchair and stop the wheelchair from moving. The caretaker or user should exert some manual strength to slow down the wheelchair using the hand rims or holding back the rear handles of the wheelchair. With the aid of the Japanese drum brake system, the caretaker may use the assisted brake to slow down the wheelchair without damaging the tires prematurely.*

2.4 Anti-tipper

Using anti-tipper substantially reduced the risk of falling over backward which can cause serious injury. The anti-tipper helps keep the user from falling backwards but they can also limit the ability to mount over curbs and some other manoeuvres. It is strongly recommended that the anti-tipper is used when the user not able to sit upright properly.



2.5 Tires

Solid PU rubber tires need minimal maintenance but should be cleaned occasionally with a damp cloth. Avoid prolonged direct sunlight UV and heat exposure. Do not use alcohol-based cleaner to wipe the tires. Replace when the tires become severely worn or cracks appear.

2.6 Front Castors

Castors should be checked periodically, and bearings shall be lubricated. Lubricate wheel bearings by removing wheel from fork. Reassemble fork and wheel by tightening nuts until no free play remains, but wheels can still roll freely. If nut is too loose, castor will swivel.

2.7 Adjusting length of footrest

When adjusting length of footrests, the user should be sitting in the wheelchair with feet on the footrests. Loosen bolt on the clamp around support assembly. Raise or lower footrest to desired position that will provide maximum support of thighs. The footrest position should not be too low that it causes uncomfortable to the user due to added pressure to thighs at front section of seat upholstery. Footrest should not be lower than 2½" from the ground to ensure clearance.

2.8 Removal of footrest during storage or transportation

Remove both pins on the footrest frame. Pull the footrest out and away from the wheelchair frame. Remember to secure the pins back into the original hole positions to avoid misplacing them.

2.9 Monthly check of rear wheels

Large rear wheels should be inspected at least once a month to ensure proper tightness. If wheel wobbles or it is loose release lock nut and tighten axle bolt slightly. Test for proper tightness by leaning chair to one side and spin the wheel to check for abnormality.

3. Maintenance & Care

3.1 General Care

Do not wash the wheelchair with a running water hose. This may damage the structure of the framework. Wipe the frame with a clean, soft cloth at least once a week. All metal parts can be cleaned with auto wax or similar products. If exposed to heavy moisture, dry immediately. Do not use an abrasive cleanser that will damage the paintwork.

3.2 Storage and transportation

- ✓ Before use, please check if any screws are loosened or missing.
- ✓ During transport and storage, the wheelchair should be properly secured and enclosed with a cover when necessary to keep excess dust and moisture away.
- ✓ Avoid moisture, high heat, or direct sunlight UV to avoid premature damage to the PU tires and armrest.
- ✓ Please avoid using the wheelchair away from rain or under the hot sun to avoid premature harm to the PU rubber part of the wheelchair.
- ✓ Storage environment temperature: $-40^{\circ}\text{C} \sim +55^{\circ}\text{C}$

3.3 Safety Guidelines

- ✓ Please practice using manual wheelchair with caretaker before going solo.
- ✓ Please do not tilt backward in a wheelchair without anti-tipper, or tilt sideward.
- ✓ Do not stand on the footrests when getting on or off the wheelchair as it may damage injury to the user.
- ✓ Do not drive wheelchair on a slope for more than 10 degrees and without proper assistance.
- ✓ Before reaching or leaning forward, rotate castors to front and then engage wheel locks.
- ✓ Be aware of your own capabilities, limitations, and strength before attempting to go up/down a ramp.

4. Limited Warranty

Your wheelchair is warranted to be free from manufacturing defects on frame and workmanship for 12 months of the original purchase date. This device was built to exact standards and carefully inspected prior to shipment. Our 12 months limited warranty coverage is an expression of our confidence in the materials and the workmanship of our products and our assurance to the user for years of dependable service. In the event of a defect covered by this warranty, we will, at our discretion, repair or replace the affected part.

This warranty does not cover device failure due to misuse or negligence of users, or normal wear and tear. The warranty does not extend to consumable components such as rubber accessories, armrests, and grips, which are subject to normal wear and need periodic replacement. In the event the device requires repair or replacement within warranty, the owner is responsible for the cost of transportation to and from our service centre.

For any after sales services, please contact your service agent/dealer and give all relevant details so that they can act accordingly. The manufacturer reserves the right to alter without notice any weights, measurements or other technical data shown. All figures, measurements and capacities shown are estimated. Our equipment which have been subjected to negligence, abuse, improper storage or handling, improper operation, unauthorized modifications or damages beyond reasonable control are not covered by the 12-month guarantee.

PROOF OF PURCHASE IN SOFT COPY OR HARD COPY MUST BE PRESENTED BEFORE ANY WARRANTY CLAIMS CAN BE CONDUCTED. WE RESERVED THE RIGHTS TO REFUSE ANY CLAIMS IF NO PROOF OF PURCHASE IS PRESENTED.

-END-